

Dear Applicant,

Please note that you must fill out all the information requested on the driveway application. Failure to do so could possibly hold up the process of acceptance.

Also, please note that if your property is located in a new subdivision, kindly submit with your application a copy of the subdivision map.

Make sure that the driveway site is staked out before submitting the application.

Thank you.

TOWN OF GARDINER



P.O.Box 1 Town Hall

Gardiner, NY 12525

Building Inspector

Donald Otis

Tele. (845) 255-9675

Fax. (845) 255-9146

To Properly Process Your Application Please Fill Out The Building Permit Form In Its Entirety And Submit All Applicable Forms

Please Submit The Following As Applicable:

- Building Permit Application (Required For All Permits)

- Proof Of Ownership (Copy Of Deed)

- Plot Plan (Required For All Permits)
 - Survey Map Showing Property Lines, Roads, (Please Indicate If Town, County, or State) And All Existing And Proposed Structures. Setback Distances For The Proposed Structure, Or Alteration/ Renovation Also Required. (OR)
 - A Copy Of The Tax Map Showing All Of The Above.

- Two Sets Of Plans Or Sketches Showing Proposed Work (Required For All Permits)
 - Must Be Stamped By A NYS Licensed Architect Or Engineer If The Estimated Cost Of The Proposed Work Exceeds \$10,000 Or if Requested By The Building Inspector.

- Ulster County Septic Approval (Required For New Houses, Additions Of Bedrooms, And/Or applications Of Increased Water Usage)

- Driveway Permit (Required If New Driveway)
 - Must Be Obtained From The Appropriate Agency (Town, County, Or State)

- Insurance Certificate (Required As Follows)
 - Contractors - Workmen's Compensation & General Liability Insurance (If contractor has no employees, a letter stating such should be filed with this office and shall exempt contractor from Workmen's Compensation Insurance)
 - Homeowners-As Requested By The Building Inspector

- Sub-Contractors Listing (If Used)

- Any Other Information As Requested By The Building Inspector

Date _____ 19____
Approved _____
Disapproved _____

Application For Building Permit
Town Of Gardiner

Do Not Write Above This Line

Building Permit No. _____
Application Date _____
Permit Fee _____

Section _____ Block _____ Lot _____ Location of Premises - Street of Road _____

Subdivision Name(if applicable) _____ Lot No _____

Zone District _____ Frontage _____ Depth _____ Rear _____ Acres or Square Feet _____

Owner _____ Builder _____

Address _____ Address _____

Telephone _____ Telephone _____

<i>Type Of Bldg:</i>	Residential Circle one (single family) (two family) If Other Explain: _____	Commercial	Other
<i>Type Of Construction:</i>		Stick Built	Modular
<i>Type Of Work:</i>	New	Addition	Renovation
	Demolition	Other	_____

Width _____ Depth _____ Height _____ Stories _____
Square Feet _____
No. of Rooms _____
No. of Kitchens _____
No. of Bedrooms _____
No. of Baths _____
Estimated Cost \$ _____

Compensation Insurance Carrier _____ No. of Policy _____ Expiration _____

File proper application with an electrical fire underwriter. Applications available at the Town Hall

Submit with this application with all applicable information as described in the following: Plot plan diagram, two sets of NYS Architect or Engineer approved plans, Ulster County Septic Approval, driveway permit, insurance certificate, and any other information required by the laws of the Town of Gardiner.

The work covered by this application may not commence before the issuance of a Building Permit. Upon completion and approval of this application, the Building Inspector will issue a Building 'permit to the applicant together with the approved duplicate of plans. Said permit shall be posted and approved plans shvll be kept on the premises available for inspection throughout the progress of construction. **No building shall be occupied or used on whole or in part for any purpose whatever until a Certificate of Occupancy or Certificate of Compliance has been granted by the Building Inspector.**

Application is hereby made to the Building Department for the issuance of a Building Permit pursuant to the New York State Uniform Fire Prevention and Building Code for the construction of buildings, additions or alterations, or the removal or demolition, as hereby described. The applicant agrees to comply with all applicable laws, ordinance and regulations.

I, *(print name)* _____ the applicant do herby certify that the above statements are true to my knowledge and belief and that any septic installation shall conform to the requirements of the parties having jurisdiction.

Date _____ Signature of Applicant _____

Address _____

Permit Expires In 12 Months

Work Must Start Within 90 Days

Final Inspection Must Be Scheduled After Completion Of Job

Total Square Footage _____
X Fee for Sq. Ft. _____
Sub Total _____
Application Fee _____
Total Due _____

TOWN OF GARDINER PLOT PLAN

BUILDING PERMIT # _____ **DATE** _____

NAME: _____ **LOCATION** _____

TYPE _____ **SBL #** _____

THE SMALLER SQUARE IN THE MIDDLE OF THE PLOT REPRESENTS THE HOUSE. PLEASE INDICATE WHERE THE SET BACKS ARE FOR THE HOUSE AND IF THIS IS A PLAN FOR A POOL, ADDITION, BARN, SHED, DECK, ETC.. PLEASE SHOW WHERE IT IS TO BE CONSTRUCTED IN REFERENCE TO THE HOUSE.
THANK YOU

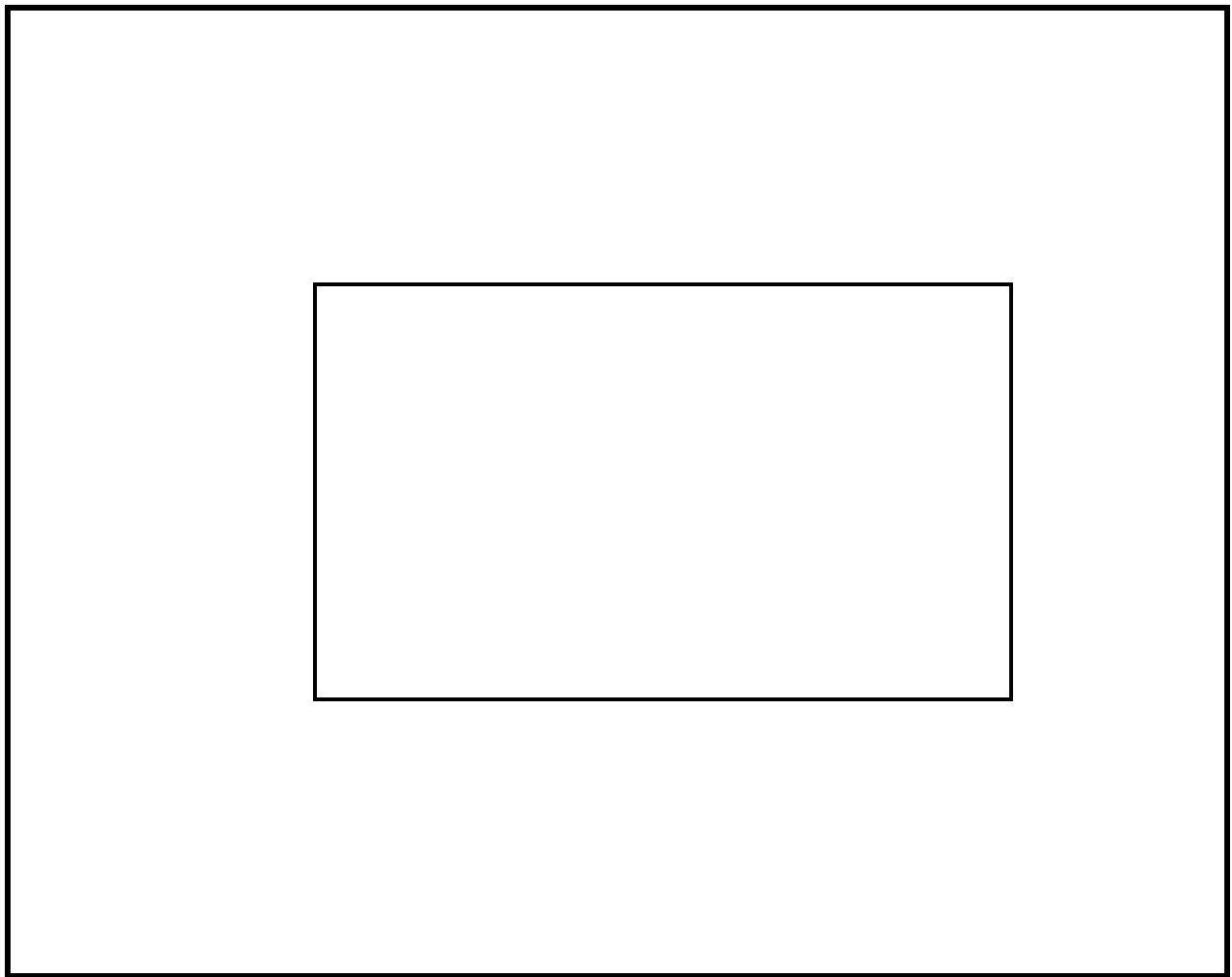

INDICATE LOCATION OF WELL AND SEPTIC TANK. IF APPLICABLE, INCLUDING THE DISTANCE BETWEEN THE WELL AND FIRST WATER OUTLET FROM SEPTIC SYSTEM

SIGNATURE _____ **DATE** _____

GARDINER BUILDING DEPARTMENT

SUB CONTRACTORS LIST

PROPERTY OWNER'S NAME: _____

PROPERTY LOCATION: _____

SBL# _____

BUILDING PERMIT #: _____

CERT. OF INS.

YES

NO

EXCAVATOR: _____

MASON: _____

FRAMER: _____

PLUMBER: _____

ELECTRICIAN: _____

TOWN OF GARDINER
Gardiner, New York 12525

APPLICATION FOR DRIVEWAY PERMIT

Date: _____ Building Permit # _____ Tax Map SBL# _____ - _____ - _____

Name of Subdivision _____

APPLICANT'S NAME: _____

STREET ADDRESS: _____ TEL.# _____

LOCATION: _____ Side of _____ (Road) _____
(.X Mi.) _____ from _____ Road

LOCATION ON LOT: (a) Attached Subdivision Map or Diagram.
(b) Stake location of driveway at ditch line.

Type of Driveway: () Single-Family Residence; () Other _____

Kind of Final Surface: () Gravel; () shale; () Paved/Blacktop _____

Limit of one (1) driveway entrance per building lot. All driveways shall enter the public highway right angles. The minimum width of driveway at the pavement line shall be fifteen (15) feet with culvert installed at the ditch line. Culvert shall be a minimum of 12" diameter CMP minimum 30 feet in length. Driveway profile shall have a negative grade of -2% slope away from Town Road for a minimum distance of 15 feet to prevent drainage upon the road surface.

Please arrange for inspections of driveway as follows:

- (1) Pre-construction: _____: (2) Placement of Culvert: _____
- (3) After covering of culvert prior to paving _____
- (4) Prior to Certificate of Occupancy _____

The undersigned applicant hereby agrees to install the proposed driveway accordance with the NYS Highway Law, Town of Gardiner Municipal code and subject to requirements of the Superintendent of Highways.

Date Signature

Date Accepted By

The above application is: () APPROVED pending construction
() APPROVED with conditions listed
() DISAPPROVED with explanation

CONDITIONS: _____

Date Charlie Haynes, Highway Superintendent

FINAL APPROVAL: _____
Date Charlie Haynes, Highway Superintendent

DIAGRAM FOR DRIVEWAY PERMIT

APPLICANT NAME _____ TAX MAP SBL# _____ - _____ - _____

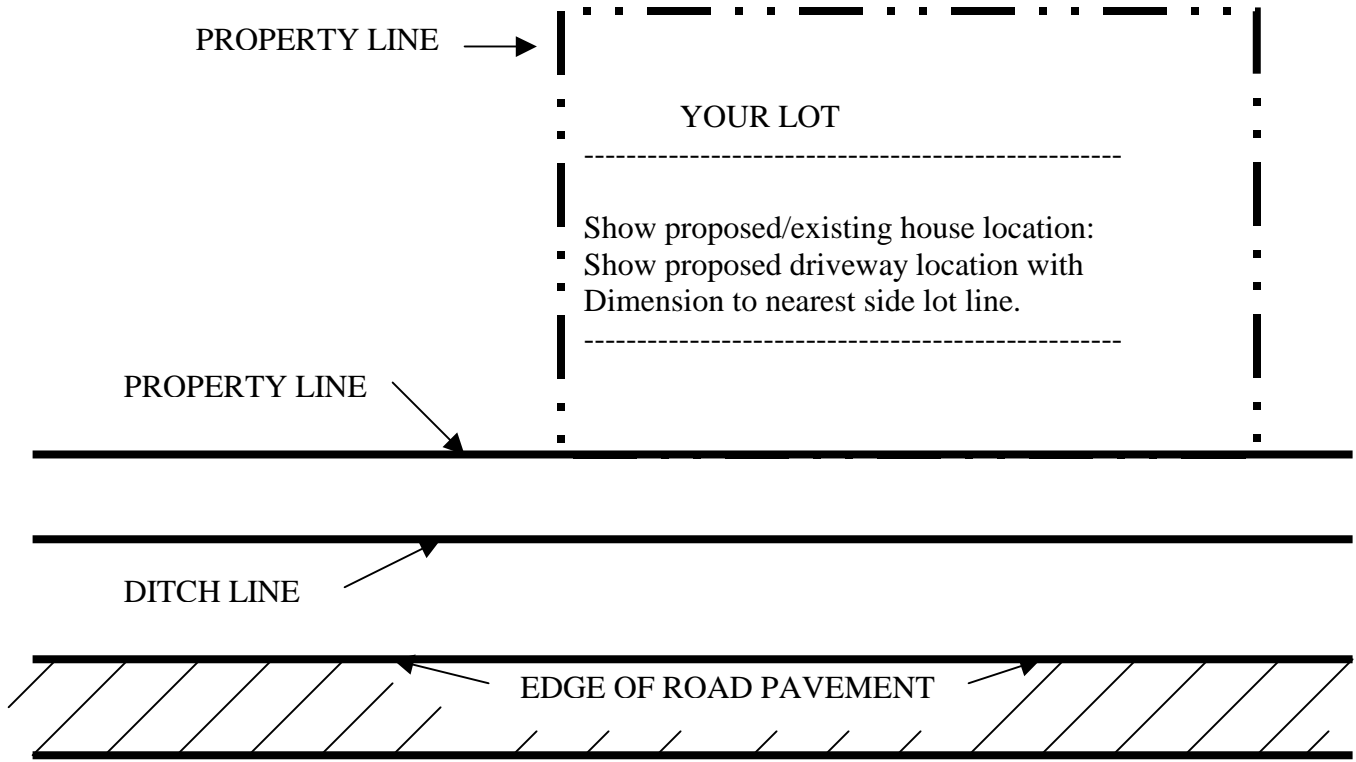

NAME OF TOWN ROAD: _____

← DISTANCE (.X MILES) AND DIRECTION TO NEAREST INTERSECTION OR LANDMARK →

_____ MILE _____ →

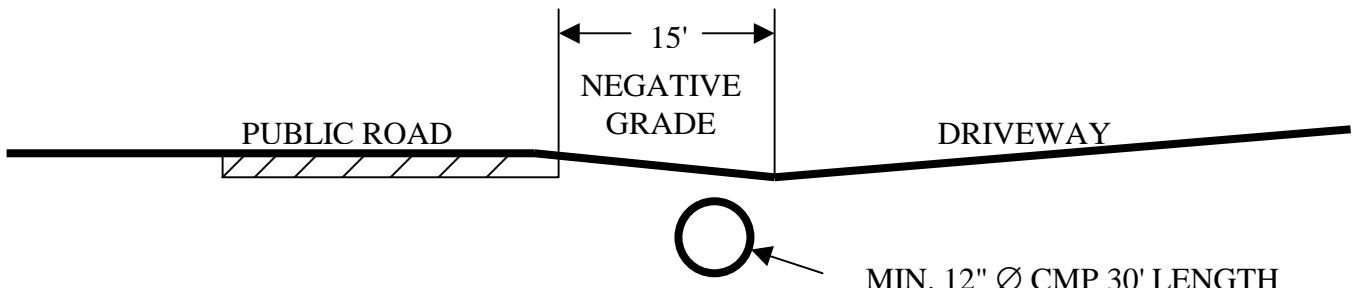

CROSS - SECTION

VEHICLE AND TRAFFIC LAW

OF THE STATE OF NEW YORK

239

§1222

- §1229. Putting glass or other injurious substances on highway prohibited.**
- (a) No person shall throw or deposit upon any highway any glass bottle. Glass, nails, tacks, wire cans, snow or any other substance likely to injure any person, animal, or vehicle upon such highway.**
 - (b) Any person who drops, or permits to be dropped or thrown, upon any highway any destructive or injurious material or any material which interferes with the safe use of the highway shall immediately remove the same or cause it to be removed.**
 - (c) Any person removing a wrecked or damaged vehicle from the highway shall remove any glass or other injurious substance dropped upon the highway from such a vehicle.**

**TOWN OF GARDINER
MUNICIPAL CODE**

ARTICLE III

LITTERING

§ 65.31 LITTERING

No person shall sweep, throw, cast, drop, put or place, or having accidentally dropped, failed to pick up any bag, bottle, bottle cap, box, container, garbage, paper, piece of paper, wrapper, or any other trash or litter, in or upon any other public street, place, park, or building, except in receptacles provided for such purposes or to permit any person under his or her control or employ to do the same.

§ 65.32 Depositing trash, snow or other debris in public streets

- A. No person shall sweep, throw or deposit, or cause to be swept, thrown or deposited, any ashes, dirt, stone, brick, leaves, grass, weeds, or any other debris or rubbish of any kind except for purposes of cleansing same into any public highway, street, gutter or public place or upon any sidewalk within the Town.
- B. No person shall throw, put, push or place or cause to be thrown, put, pushed, or laced, any snow or ice into any public highway, street, public place or thoroughfare in the Town
- C. This section shall not apply to water or liquids running into streets as a result of fire fighting or flushing of fire hydrants by authorized personnel or the use in a reasonable manner of ashes, salt or other material for the purpose of reducing the hazard of, or providing traction on snow, ice or sleet.

§ 65.33 Littering by trucks or other vehicles

No truck or other motor vehicle or trailer or other motor conveyance shall be operated or loaded in such a manner that any part or portion of its load, whether sand, gravel, stone, dirt, rubbish, paper, boxes, trash or other material shall be dropped, blown or caused to fall or dropped upon any public street, highway, public place, or thoroughfare in Town.

Mail Box Placement

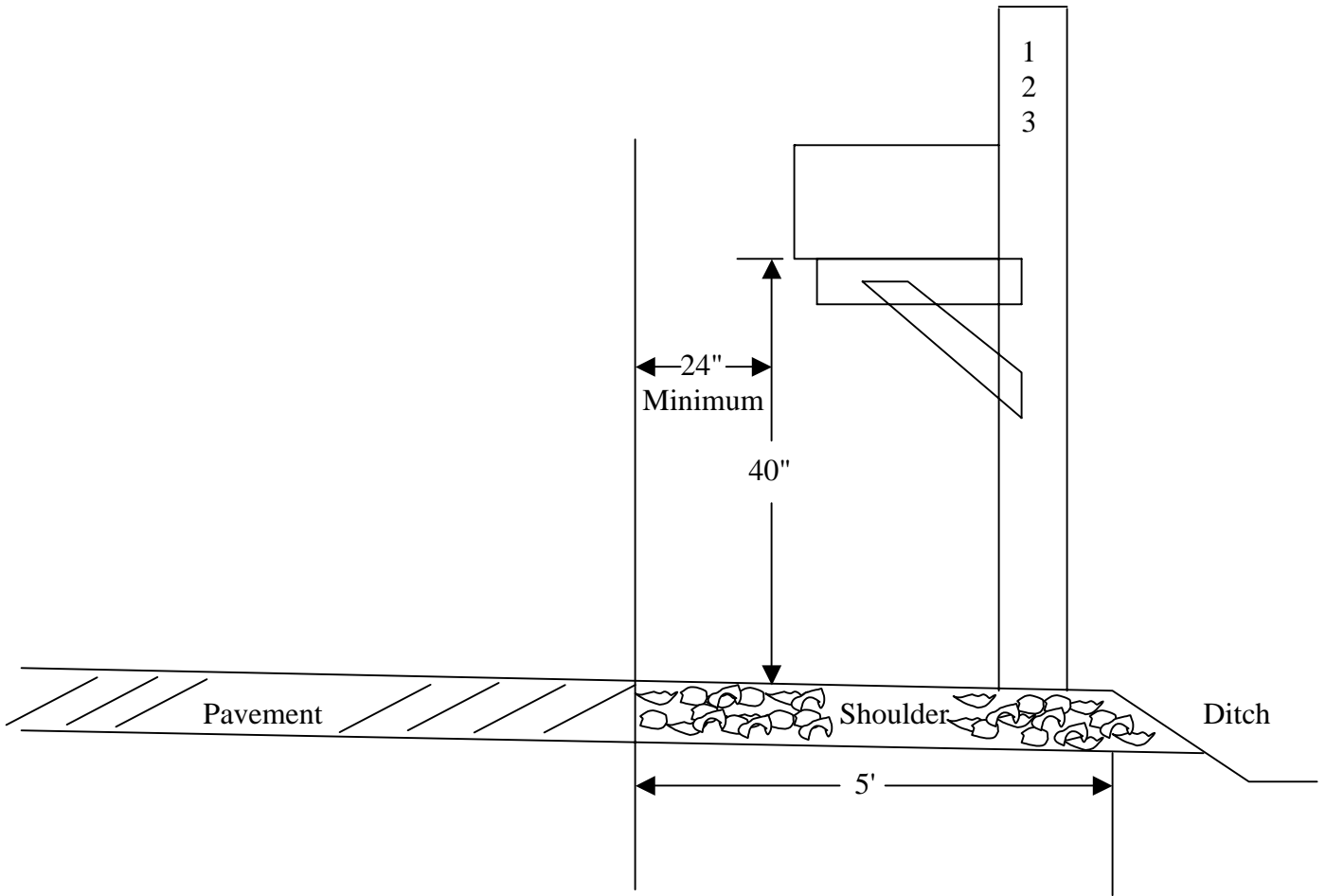

FIGURE 8